

Bore Specification Sheet

Attention: _____
 Phone #: _____
 From: _____
 Date: _____

Company: _____
 Fax #: _____
 Customer #: _____ P.O. #: _____
 # of Pages: _____ (Including this page)

Please note: Doors less than 30" width or with applied moulding may require a modified design to allow for certain backsets. All "TIL" units require raised moulding, therefore 2-3/4" backset choice for this style is not available without customization. Please call for details.

Any handlesets purchased or provided will be fit, however, they will subsequently be removed for shipping purposes and the hardware will arrive in a separate box.

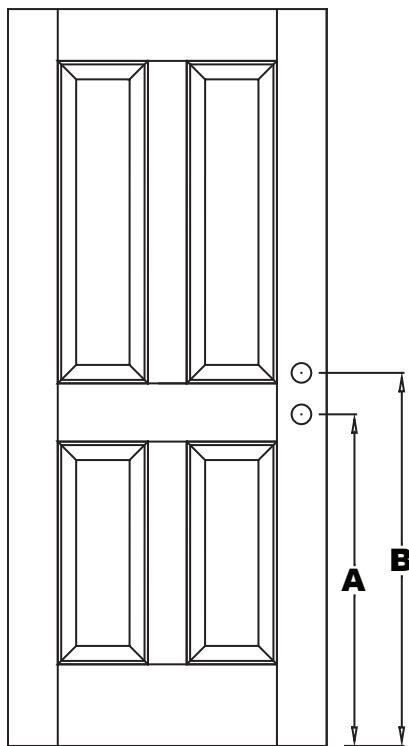

- A** **Height from bottom of door to center of latch bore**
 Write 36" for standard height, or a custom measurement of your choosing.
- B** **Height from bottom of door to center of deadbolt bore**
 Write 41 1/2" for standard height, or a custom measurement of your choosing. See your handle set boring instructions or center-to-center notation (if one piece handle set)
- C** **Backset**
 Common backsets are 2 3/8" and 2 3/4" or a custom measurement of your handle set. See diagram C below.

- D** **Swing of door, viewed from exterior**
 Check **one** of the following. (For a double door unit, check the one corresponding to the active door.)

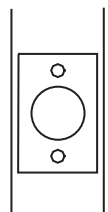
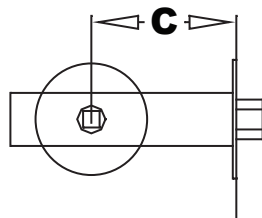

LHH Inswing

RHH Inswing

LHH Outswing

RHH Outswing

Interior
 Exterior

Name: _____ Signature: _____ Date: _____

